

01.13....
Model 'Comfort-NG'
for cows
mounted to
60 mm support post

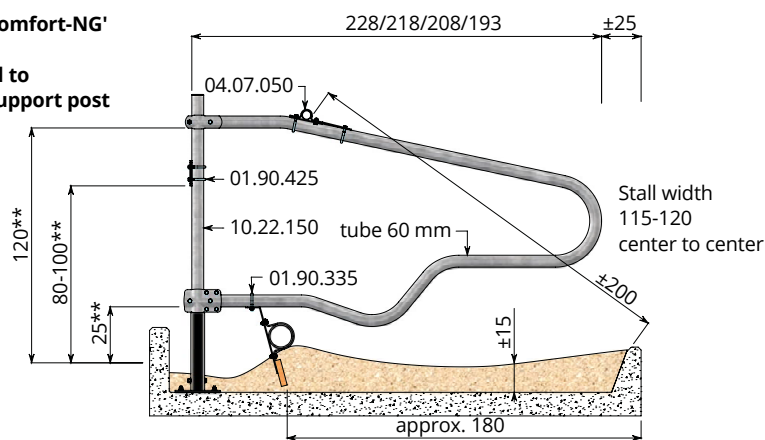

deep litter freestall

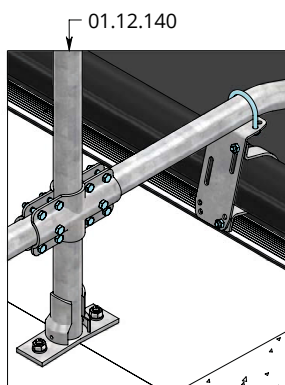
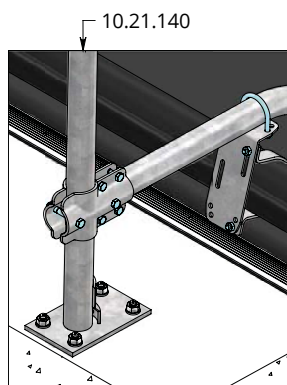

01.13....
Model 'Comfort-NG'
for cows
Double row
mounted to
60 mm support post

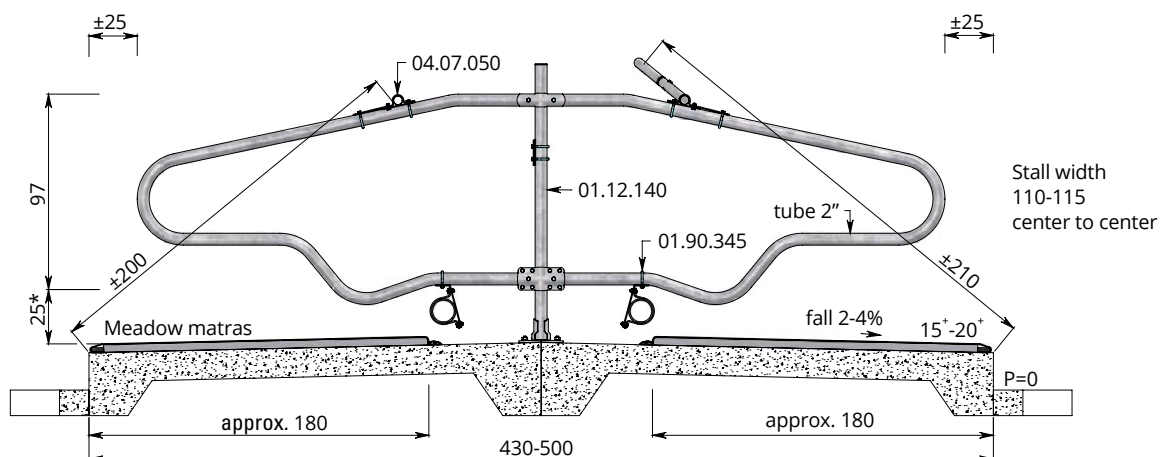

item-no.

Freestall divider for cows, model 'Comfort-NG', mounted to support post 60 mm (T-clamps or four-way clamps are included)

01.13.560	Model 'Comfort-NG' 218 - stall floor ≥ 250 cm
01.13.550	Model 'Comfort-NG' 208 - stall floor 240 cm
01.13.530	Model 'Comfort-NG' 193 - stall floor 220 cm
01.13.575	Model 'Comfort-NG' 228/228 - stall floor 500 cm
01.13.565	Model 'Comfort-NG' 218/218 - stall floor 480 cm
01.13.555	Model 'Comfort-NG' 208/208 - stall floor 460 cm
01.13.545	Model 'Comfort-NG' 193/208 - stall floor 445 cm
01.13.535	Model 'Comfort-NG' 193/193 - stall floor 430 cm

Fittings

04.07.050	Shoulder rail strap clamp 48 x 60 mm
10.21.140	Floor-mounted support post 60 mm x 140 cm (item no. for single row)
01.12.140	Floor-mounted support post 60 mm x 140 cm (item no. for double row)
10.21.150	Floor-mounted support post 60 mm x 150 cm (item no. for deep litter system)
10.20.160	Support post 60 mm x 160 cm
11.02.200	Plastic protective sleeve 60 mm
11.06.200	Stopper 60 mm
11.11.250	Floor anchor M16 x 120 mm (use 4 when installing a single row) (use 2 when installing a double row)
11.12.016	Chemical anchor M16 (10 anchors)
10.15.600	Tube 48 mm, length 6 m
04.21.015	Tube clamp coupling 48 mm
04.24.115	Adjustable end coupling
04.08.010	Matching cross clamp 48 x 48 mm
01.90.345	Knee rail support for PE125
01.90.425	Belt clamp for 60 mm tubing (bolts and nuts are included)
01.90.400	Retainer belt 50 mm, 100 m roll
01.90.405	Retainer belt 50 mm, 50 m roll

'Comfort' for deep litter freestalls

10.22.150	Floor-mounted support post 60 mm x 150 cm (deep litter system), mounting foot additional treated with a durable epoxy coating
11.11.240	Floor anchor M12 x 106 (3 per support post)
01.90.335	Knee rail support for PE125, for deep litter freestall

* - measured from the top of the cow mattress
** - measured from the top of the litter bed

Waved neck bar

With the waved neck bar the shoulder height or diagonal boxside - neck rail can be raised up till 30 cm (see page 18).

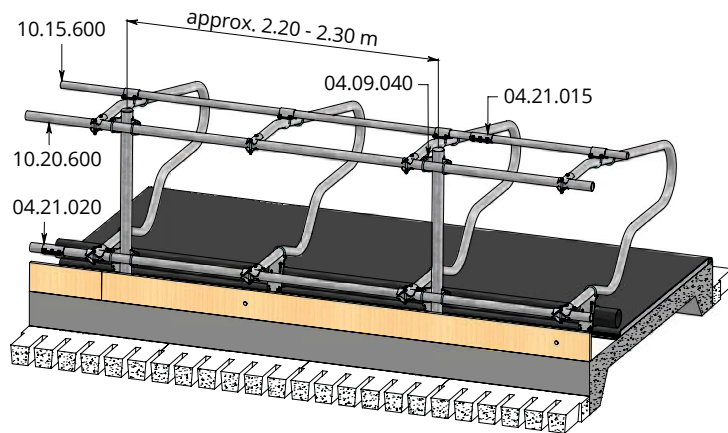

Mounted to horizontal tubing; stall adjustable in height and width.

01.13....
Model 'Comfort-NG'
for cows
Double row
mounted to
horizontal tubing

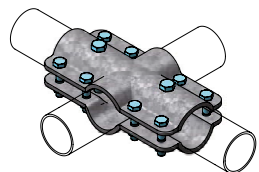

Detail B

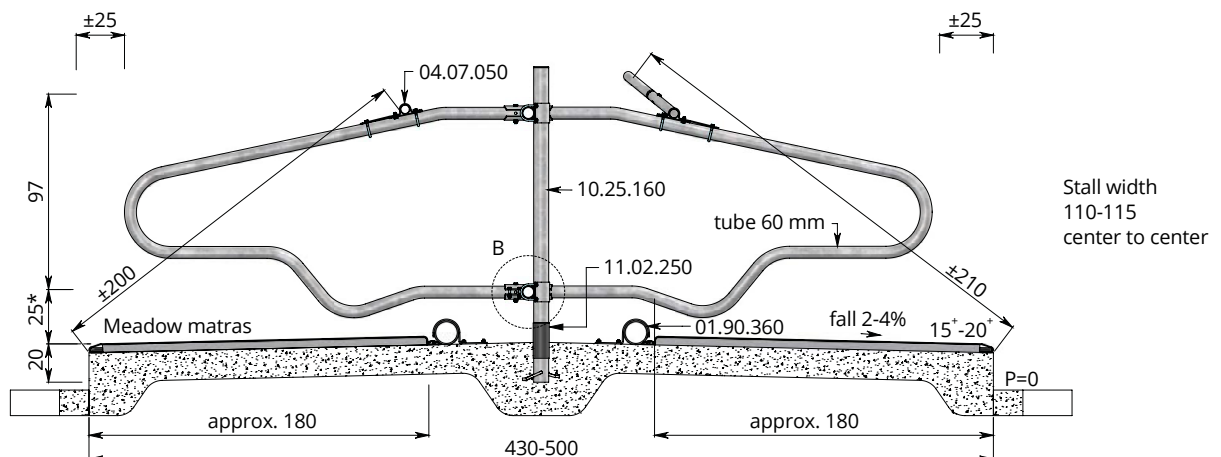

Freestall divider model 'Comfort-NG', mounted to horizontal tubing

Important advantages:

- Shoulder rail height 120 cm, therefore plenty of room for getting up and laying down;
- Freedom when resting due to the special design;
- Durability, due to the suspended construction;
- Adjustable in height and width;
- Stall is easy to clean;
- Meadow mattress or FriesKo water bed can be placed without any problem;

item-no.

Freestall divider for cows, model 'Comfort-NG',
mounted to horizontal tubing
(T-clamps or four-way clamps are included)

01.13.560	Model 'Comfort-NG' 218 - stall floor ≥ 250 cm
01.13.550	Model 'Comfort-NG' 208 - stall floor 240 cm
01.13.530	Model 'Comfort-NG' 193 - stall floor 220 cm
01.13.575	Model 'Comfort-NG' 228/228 - stall floor 500 cm
01.13.565	Model 'Comfort-NG' 218/218 - stall floor 480 cm
01.13.555	Model 'Comfort-NG' 208/208 - stall floor 460 cm
01.13.545	Model 'Comfort-NG' 193/208 - stall floor 445 cm
01.13.535	Model 'Comfort-NG' 193/193 - stall floor 430 cm

Fittings

04.07.050	Shoulder rail strap clamp 48 x 60 mm
10.25.160	Support post 76 mm x 160 cm
11.02.250	Plastic protective sleeve 76 mm
11.06.250	Stopper 76 mm
10.26.130	Floor-mounted support post 76 mm x 130 cm
11.11.250	Floor anchor M16 x 120 mm
11.12.016	Chemical anchor M16 (10 anchors) an alternative to floor anchor
04.09.040	Strap clamp 76 x 60 mm
10.15.600	Tube 48 mm, length 6 m
04.21.015	Tube clamp coupling 48 mm
10.20.600	Tube 60 mm, length 6 m
04.21.020	Tube clamp coupling 60 mm
04.24.115	Adjustable end coupling
04.08.010	Matching cross clamp 48 x 48 mm
04.24.020	End coupling 60 mm
01.90.360	Mounting clip for knee rail PE125
11.11.210	Floor anchor M10 x 71 (2 per mounting clip)

* - measured from the top of the cow mattress

Waved neck bar

With the waved neck bar the shoulder height or diagonal boxside - neck rail can be raised up till 30 cm (see page 18).

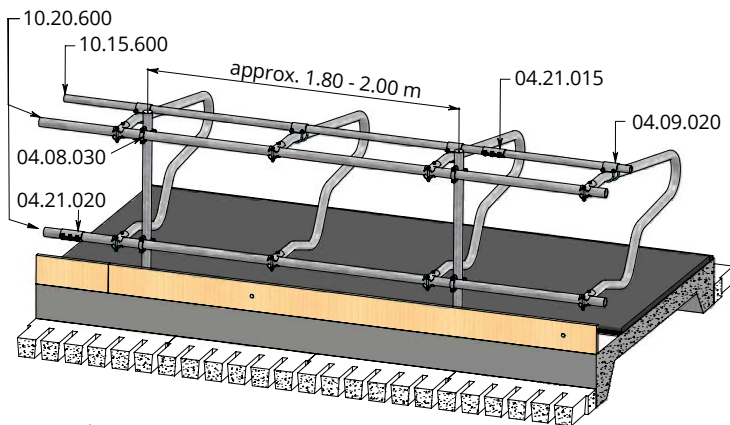

Mounted to 60 mm horizontal tubing: stall adjustable in height and width

01.31.630
Heifers,
10-18 months
Single row

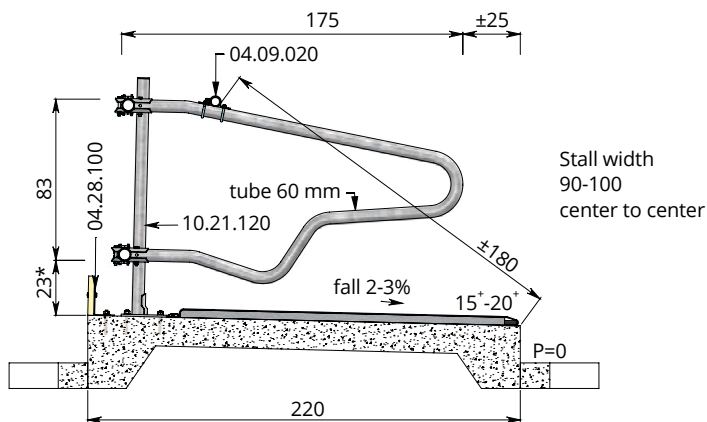

01.31.620
6-10 months
Single row

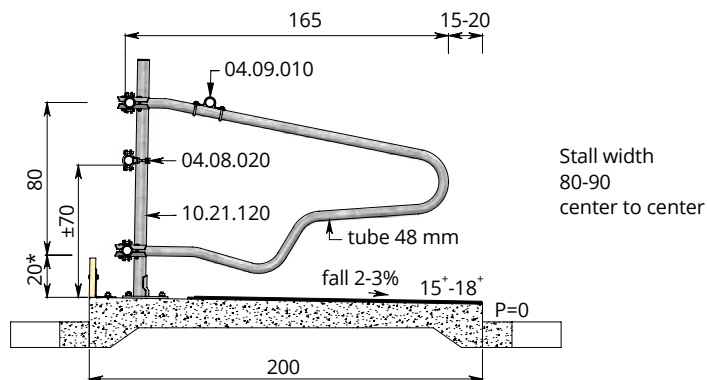

01.31.610
2-6 months
Single row

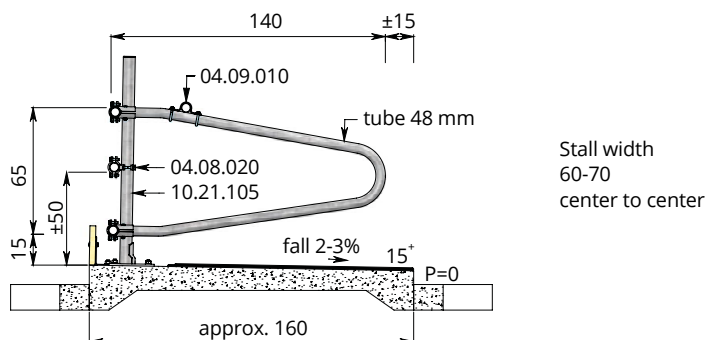

Heifers and young stock are the future of a dairy herd, therefore they need to be well cared for. Dairy farmers working with a freestall system for every age group get better results. Housing of the animals in dry, well-designed stalls with comfortable dividers, is essential for the development of these animals.

item-no.

Heifers 18-22 months,
stall width 100-110 center to center

01.13.530

Single row 60 mm, (T-clamps included)
Model 'Comfort-NG' 193

01.13.535

Double row 60 mm, (four-way clamps included)
Model 'Comfort-NG' 193/193

Fittings

See page 6

Heifers 10-18 months,
stall width 90-100 center to center

01.31.630

Single row 60 mm, (T-clamps included)

01.31.635

Double row 60 mm, (four-way clamps included)

Fittings

04.09.020 Strap clamp 48 x 60 mm

11.06.200 Stopper 60 mm

10.21.120 Floor-mounted support post 60 mm x 120 cm

11.11.250 Floor anchor M16 x 120 mm

11.12.016 Chemical anchor M16 (10 anchors)

an alternative to floor anchor

04.08.030 Cross clamp 60 x 60 mm

10.15.600 Tube 48 mm, length 6 m

04.21.015 Tube clamp coupling 48 mm

10.20.600 Tube 60 mm, length 6 m

04.21.020 Tube clamp coupling 60 mm

04.24.115 Adjustable end coupling

04.08.010 Matching cross clamp 48 x 48 mm

04.24.020 End coupling 60 mm

04.28.100 Angle support 10 x 14 cm

Calves 6-10 months

01.31.620

Single row 48 mm, (T-clamps included)

01.31.625

Double row 48 mm, (four-way clamps included)

Calves 2-6 months

01.31.610

Single row 48 mm, (T-clamps included)

Fittings

04.09.010 Strap clamp 48 x 48 mm

11.06.200 Stopper 60 mm

10.21.120 Floor-mounted support post 60 mm x 120 cm

10.21.105 Floor-mounted support post 60 mm x 105 cm

11.11.250 Floor anchor M16 x 120 mm

11.12.016 Chemical anchor M16 (10 anchors)

an alternative to floor anchor

04.08.020 Cross clamp 48 x 60 mm

10.15.600 Tube 48 mm, length 6 m

04.21.015 Tube clamp coupling 48 mm

04.24.115 Adjustable end coupling

04.08.010 Matching cross clamp 48 x 48 mm

04.24.015 End coupling 48 mm

04.28.100 Angle support 10 x 14 cm

* - measured from the top of the cow mattress